



9 Strath Nairn

, Law, ML8 5LL

Offers over £115,000

CLOSING DATE SET - THURSDAY 27TH JULY AT NOON

Rarely available, a lovely semi detached bungalow central to Law, by Carluke.

This charming property comprises reception hall, large lounge, fitted kitchen, two double bedrooms and bathroom

Further benefits include spacious private landscaped gardens to front and rear as well as a driveway to the side of the property leading to a brick built garage.

Double Glazing. Gas Central Heating. EPC C.

Strath Nairn is centrally located within Law Village and situated close to a selection of shops, the local Primary school and public transport links. For the commuter it is ideally situated for Glasgow, Edinburgh and the central belt via the M8 & M74 motorway networks.

- Semi Detached BUNGALOW
- Two double bedrooms
- private gardens to front and rear
- driveway
- garage

Viewing

Please contact our Pomphreys Properties Ltd Office on 01698373365 if you wish to arrange a viewing appointment for this property or require further information.



2



1



1



Floor Plan

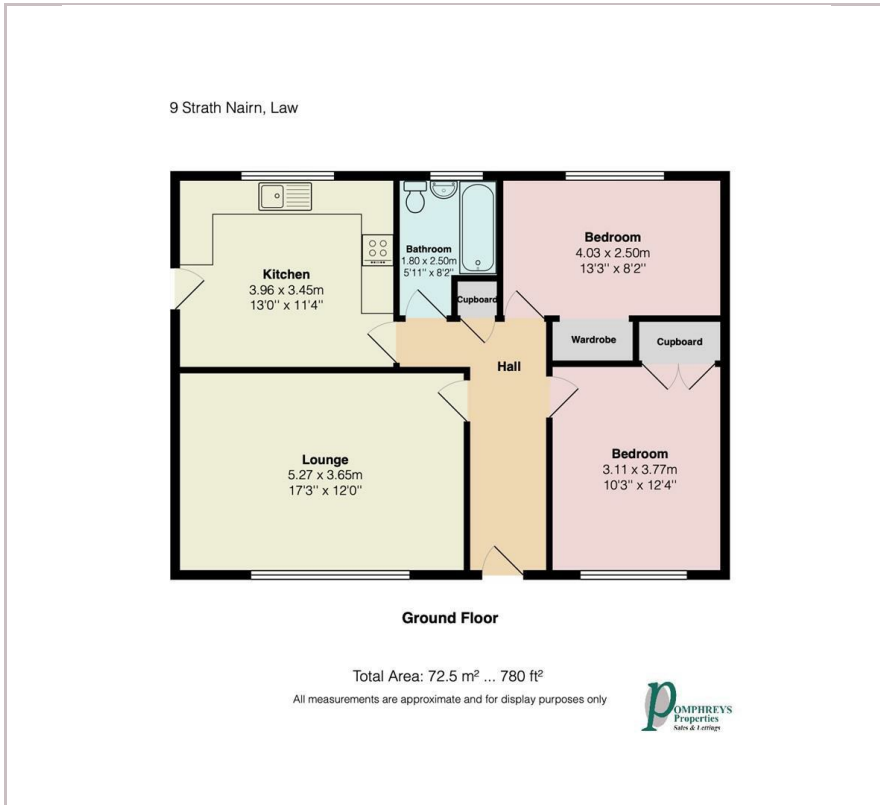

Area Map



Energy Efficiency Graph



These particulars, whilst believed to be accurate are set out as a general outline only for guidance and do not constitute any part of an offer or contract. Intending purchasers should not rely on them as statements of representation of fact, but must satisfy themselves by inspection or otherwise as to their accuracy. No person in this firms employment has the authority to make or give any representation or warranty in respect of the property.