

first for homes

first for property in life - [firstforhomes.co.uk](https://www.firstforhomes.co.uk)

Contact Allan England's Team

01592 752 944



NINA, Easy Living Developments, Plot 036, 037, 038, 039, 043 & 044, Kings Meadow, Coaltown of Balgonie

Price £205,000

Kings Meadow, Coaltown of Balgonie

The "NINA" - A 2 BEDROOM SEMI DETACHED VILLA WITH DRIVWAY. Built By Easy Living Developments!

Allan England's team at First for Homes are proud to offer for sale this impressive 2-Bed Semi-Detached Bungalow (59.6m2) located in a highly sought-after new development of Kings Meadow, Coaltown of Balgonie and built by Easy Living Developments, a Fife based multi award winning builder you can trust to build your dream home.

This stunning high specification new build provides spacious and luxurious family living accommodation comprising lounge with french doors leading to rear garden, modern high specification German kitchen (with NEFF integrated appliances including Fridge Freezer, Hob, Oven, Dishwasher, Washerdryer), a spacious bathroom with buyers choice of walk-in shower or bath with overhead shower, 2 double bedrooms, both with fitted wardrobes. Private driveway with space for two vehicles. EV charging points as standard. Option to include solar panels. Ground Source Heating

- * Photographs for Illustration Purposes Only
- * Reservation Fee Applies
- * Call to Enquire

- Stunning 2-Bed Semi-Detached Bungalow "NINA"
- BUILT BY EASY LIVING DEVELOPMENTS
- New Development Kings Meadow, Coaltown of Balgonie
- Lovely Lounge with French Doors Lead to Rear Garden
- 2 Double Bedrooms with Fitted Wardrobes
- High Quality German Kitchen and NEFF Appliances Included
- Choice of Luxury Bathroom/Showerroom
- Garden Grounds & Driveway
- EV charging points as standard. Option to include solar panels. Ground Source Heating





SITUATION – Coaltown of Balgonie

PHOTOGRAPHS (Illustration Purposes Only)

HALLWAY 13'0" x 7'9" approx (3.97m x 2.37m approx)

LOUNGE 11'2" x 14'0" approx (3.42m x 4.29m approx)

KITCHEN 8'1" x 10'1" approx (2.47m x 3.08m approx)

BEDROOM 1
10'2" x 9'1" approx (3.12m x 2.78m approx)

BEDROOM 2 9'1" x 9'1" approx (2.78m x 2.78m approx)

SHOWER ROOM

GARDEN GROUNDS

DRIVEWAY

INFORMATION

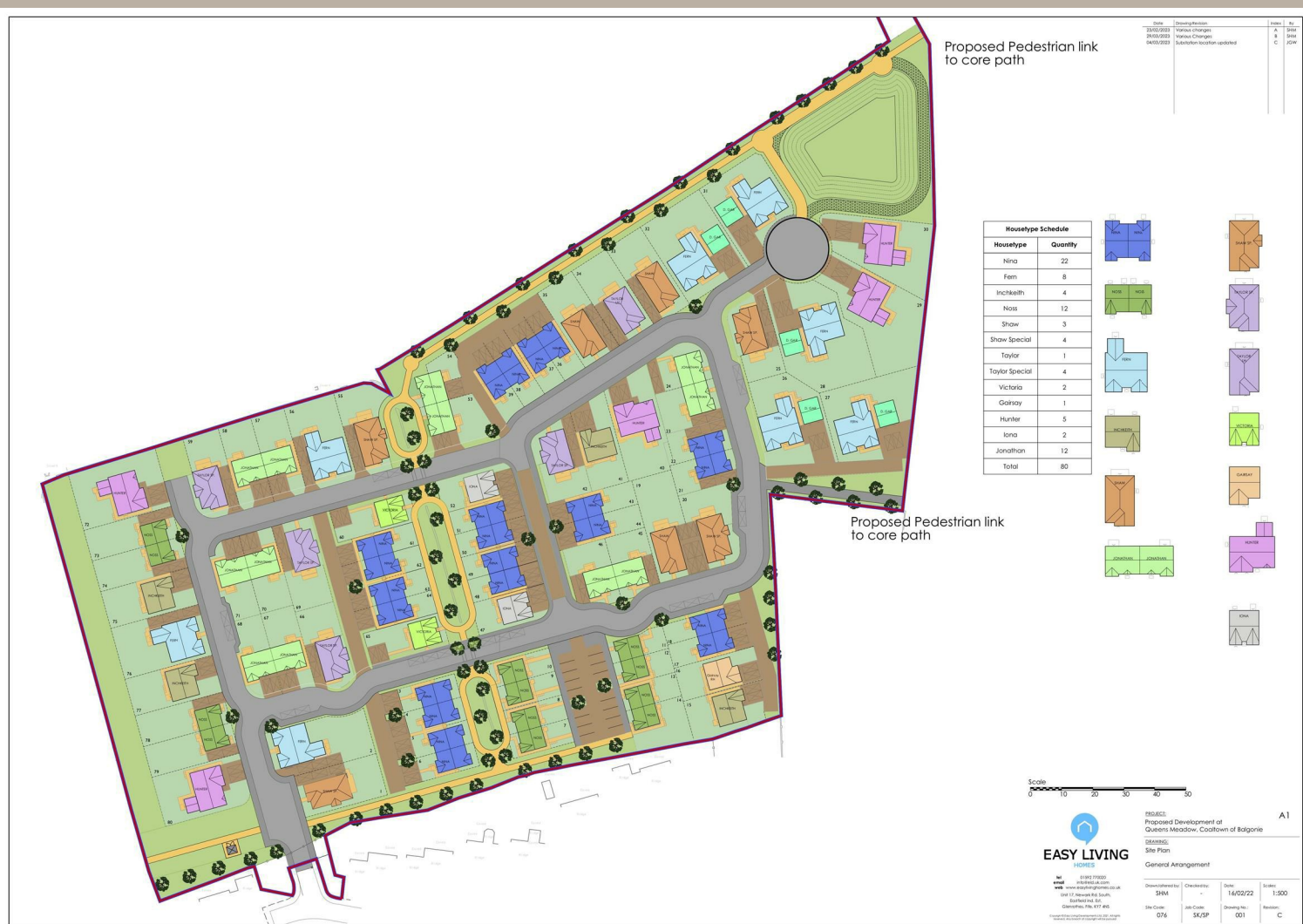

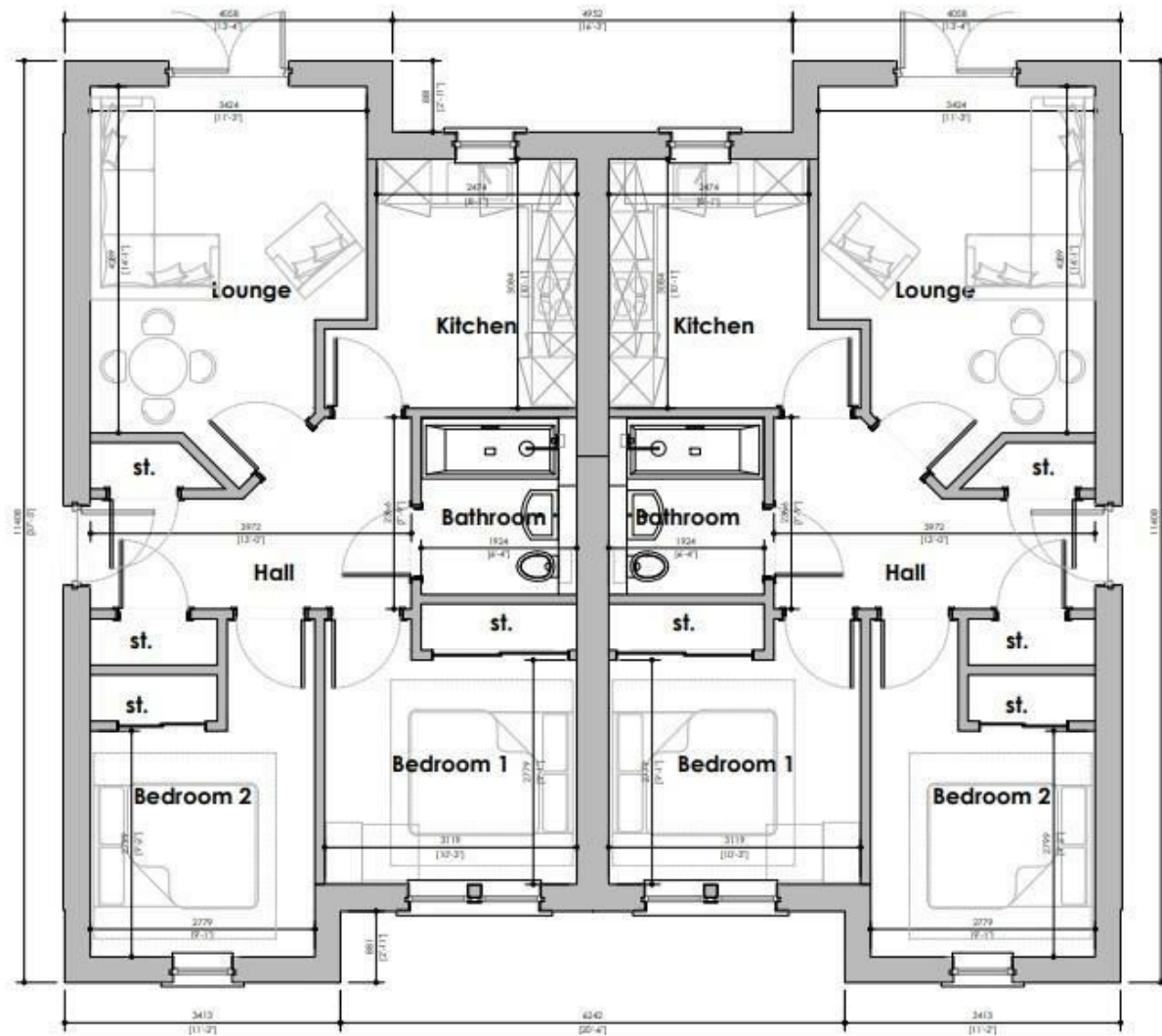

Floor Plan, Plot A
Area - 59.6m²

Floor Plan, Plot B
Area - 59.6m²

Information

These particulars are prepared on the basis of information provided by our clients. We have not tested the electrical system or any electrical appliances, nor where applicable, any central heating system. All sizes are recorded by electronic tape measurement to give an indicative, approximate size only. Prospective purchasers should make their own enquiries – no warranty is given or implied. This schedule is not intended to, and does not form any contract.

FREE Valuation

Selling Your Home?

Choose first for homes - a highly experienced estate agency team you can trust to sell your home at the highest possible price. Offering fantastic savings on selling fees, with no compromise on service, free professional photography highlighting your home in its best light, first for homes will be your first choice. Contact us today to arrange your appointment.



first for trust



first for service



first for aftercare

first for homes
first for property in life - firstforhomes.co.uk

Contact Allan England's Team
01592 752 944

32 North Street, Glenrothes, Fife KY7 5NA
Fax: 01592 807947
sales@firstforhomes.co.uk
www.firstforhomes.co.uk